

Protecta FR Acrylic - 100mm Concrete Floor Steel, Copper, Alupex Pipe (Continuous Non-combustible Insulation)

Installation Instructions

1. Before installing Protecta® FR Acrylic ensure that the surface of all service penetrations and surrounding construction is free from all loose contaminants, dust and grease.
2. Where Protecta® FR Acrylic is to be installed against surfaces that cannot tolerate direct contact; appropriate surface preparation should be made (contact Polyseam for guidance in these cases). For paints sensitive to sealing compounds, priming with a PVA primer is recommended.
3. As Protecta® FR Acrylic is water based, in cases where corrosion protection is a problem; some metals may require a barrier between the sealant and the metal surface prior to this installation.
4. When installing any backing material, cut this slightly oversize and insert into the gap ensuring a tight friction fit. Ensure correct depth is achieved.
5. Fill the gap or joint with Protecta® FR Acrylic to the required depth.
6. Apply the sealant generously to prevent air bubbles. Finish the bead with a moist spatula, pallet knife or brush.
7. Protecta® FR Acrylic can be over-painted with most emulsion or alkyd (gloss) paints.

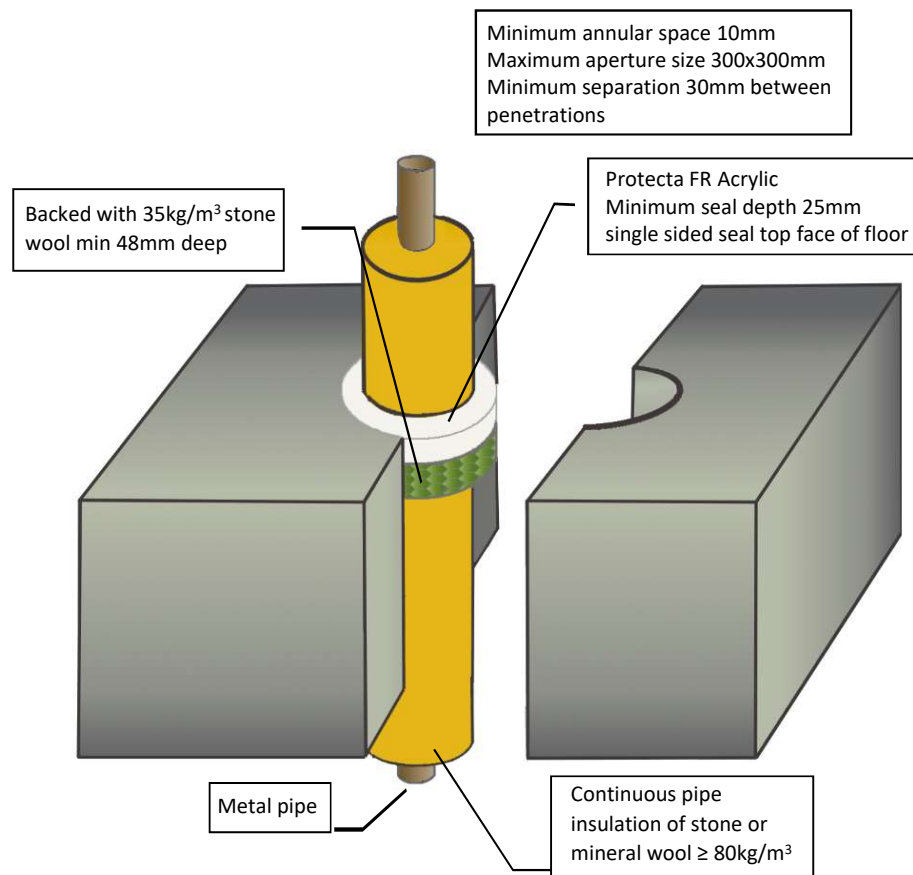

System/FPA Register ID# FC302

Products	Protecta FR Acrylic Stone wool
Application	Fire stopping of insulated metal pipes in rigid floors
Construction	Minimum floor thickness of 100mm and comprise aerated concrete or concrete with a minimum density of 650kg/m ³ .

Fire & Sound classification

Steel pipe up to 324mm diam (up to 14.2mm wall) with 30-80mm thick insulation
FRR -/240/240

Copper pipe up to 12mm diam (up to 6mm wall) with 20-80mm thick insulation
FRR -/240/240

Copper pipe up to 54mm diam (up to 14.2mm wall) with 20-80mm thick insulation
FRR -/240/180

Alupex pipe up to 75mm diam (up to 4.6mm wall) with 20-50mm thick insulation
FRR -/180/120

Approved for concrete floors down to 100mm with FRR reduced to the FRR of the floor.

ZERO smoke leakage up to 200Pa

Sound reduction (seal only) STC 62

As a part of our policy of on-going product development and testing, we reserve the right to modify, alter or change product specifications without giving notice. All information contained in this document is given in good faith and is provided for guidance only. Any drawings provided are for illustrative purposes only. As Polyseam has no control over the methods or competence of installation and of prevailing site conditions, no warranties, expressed or implied, is intended to be given as to the actual performance of the product mentioned or referred to herein and no liability whatsoever will be accepted for any loss, damage or injury arising from the use of the information given.

Sheet size: **A4** | Drawn date & no: 24/5/21

Scale: **NTS** | Drawn by: **K.B**